



ROBINSONS TEES VALLEY are delighted to offer to the market this well cared for and deceptively spacious detached bungalow situated in the sought after Nunthorpe location. The bungalow occupies an excellent plot in this pleasant cul-de-sac and would appeal to a variety of buyers. The extensive living accommodation briefly comprises; entrance hallway, shower room/WC, attractive fitted kitchen, modern family bathroom fitted with a three piece suite, two double bedrooms with fitted wardrobes, good size lounge/diner to the front aspect with three windows providing plenty of natural light, rear study leading to a large conservatory which has lovely views of the garden. Externally to the front of the property is off street parking for 2 cars leading to the integral garage which has room for one small vehicle inside and a well maintained garden. To the rear is a generous size garden which is not overlooked and has a high degree of privacy, mainly laid to lawn with patio areas and established borders. Early viewing comes highly recommended.

**Allerton Park, Middlesbrough, TS7 0LW**

**2 Bedroom - House**

**£290,000**

**EPC Rating: D**

**Tenure: Freehold**

**Council Tax Band: D**

**ROBINSONS**  
SALES • LETTINGS • AUCTIONS *Tees Valley*



Allerton Park, Middlesbrough, TS7 0LW



For clarification we wish to inform prospective purchasers that we have prepared these sales particulars as a general guide. We have not carried out a detailed survey, nor tested the services, appliances and specific fittings. Room sizes should not be relied upon for carpets and furnishings, if there are important matters which are likely to affect your decision to buy, please contact us before viewing the property. Robinsons Tees Valley can recommend financial services, surveying and conveyancing services to sellers and buyers. Robinsons Tees Valley staff may benefit from referral incentives relating to these services.

Visit. . [robinsonsteesvalley.co.uk](http://robinsonsteesvalley.co.uk)

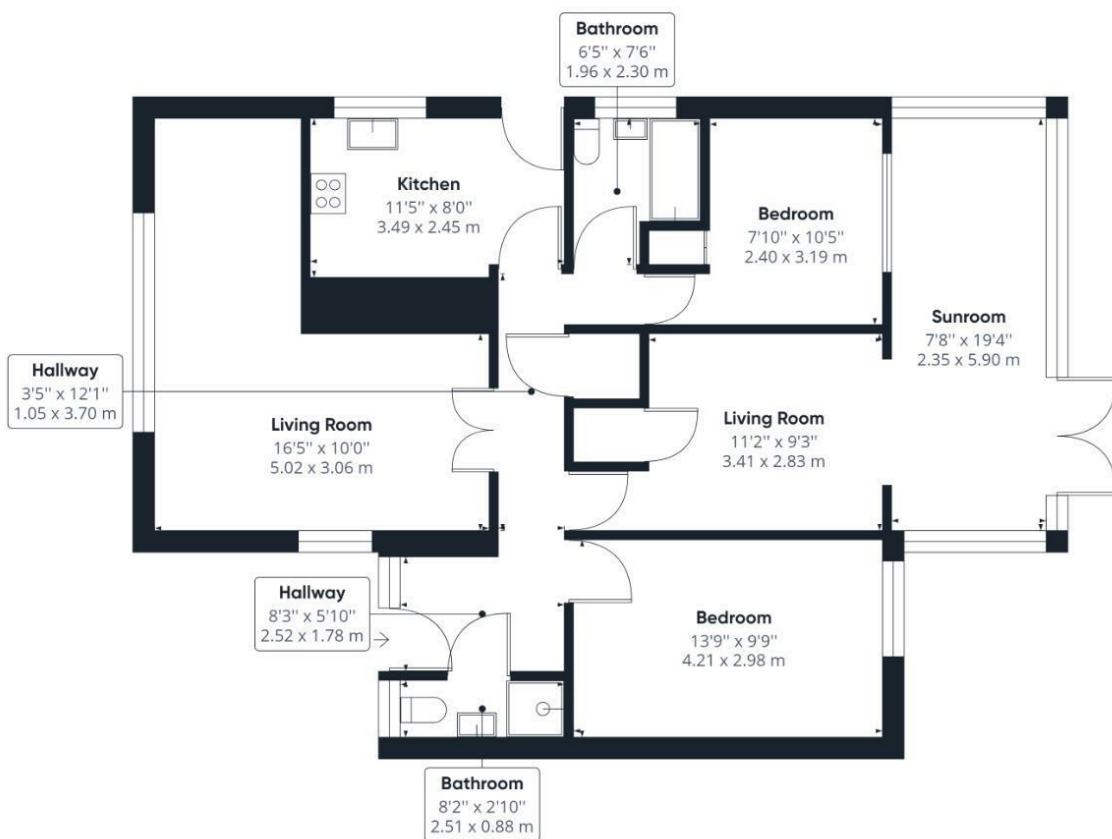

**Approximate total area<sup>(1)</sup>**  
1041.06 ft<sup>2</sup>  
96.72 m<sup>2</sup>

(1) Excluding balconies and terraces

While every attempt has been made to ensure accuracy, all measurements are approximate, not to scale. This floor plan is for illustrative purposes only.

GIRAFFE 360

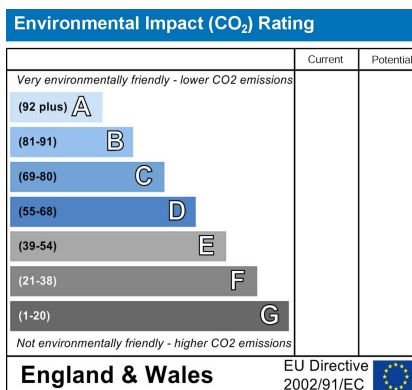
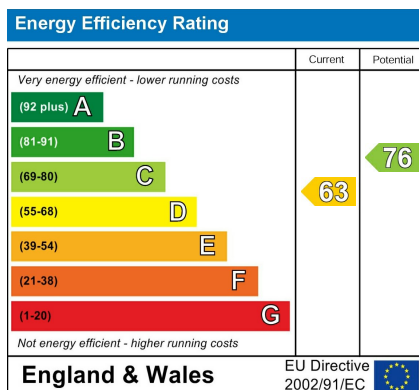

**Robinsons Tees Valley**  
Middlesbrough Sales, TS7 8DX  
01642 313666  
middlesbrough@robinsonsteesvalley.co.uk  
[www.robinsonsteesvalley.co.uk](http://www.robinsonsteesvalley.co.uk)